

Tondo orientabile - Round adjustable

P.388

Materiale - Material
ABS termoresistente - Thermoresistent ABS

Colore - Colour
Nero - Black

Pezzi confezione - Package items
secondo codice - according to item code

Volume e dimensioni confezione
Package volume and size
secondo codice - according to item code
* 12,7 dm³ - 230 X 210 X 240 mm
** 24,3 dm³ - 400 X 280 X 200 mm

Peso confezione - Package weight
secondo codice - according to item code

SPQ Ricambi - Spare parts
-

Accessori - Accessories



Sezione utile passaggio aria -
Open air flow section: 1.838 mm²

Temp. di esercizio - Working temp.
-10/+70 °C (14/158 °F)

LEX Normative - Norms
R107.8; R118.3; FMVSS 302; ISO 3795; REACH; ROHS; CMR.
More info on page C2-C3 and website on "Directives and regulations" area.

P.388

Cod.	Tipo - Type	Corpo diffusore - Air diffuser body			Anello esterno - External ring		n°	dm	g	Min
		S mm	Colore Colour	Finitura Finishing	Si/No Yes/No	Finitura Finishing				
67871	1	3	nero - black	soft touch	No	-----	50	12,7*	2.800	500
67881	1	3	nero - black	erosa - matt	No	-----	100	12,7*	2.800	
65032	2	10	nero - black	erosa - matt	Yes	nero - black (standard)	50	24,3**	4.500	
64942	2	10	nero - black	erosa - matt	Yes	silver (lucida/bright)	50	24,3**	4.500	
65152	2	10	nero - black	erosa - matt	Yes	silver (semilucido/semibright)	50	24,3**	4.500	
63832	2	10	nero - black	soft touch	Yes	silver (lucida/bright)	50	24,3**	4.500	500
63842	2	2	nero - black	soft touch	Yes	silver (lucida/bright)	50	24,3**	4.500	500
61093	2	2	nero - black	soft touch	Yes	nero - black (standard)	50	24,3**	4.500	500
65202	2	2	nero - black	erosa - matt	Yes	silver (lucida/bright)	50	24,3**	4.500	
68382	2	2	nero - black	erosa - matt	Yes	nero - black (standard)	50	24,3**	4.500	

P.388

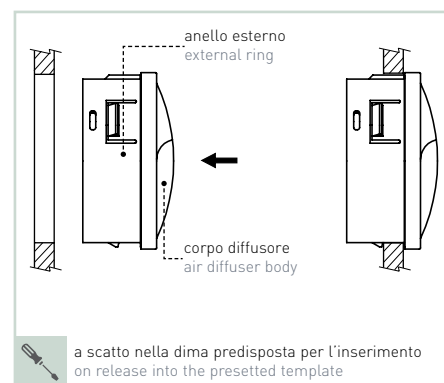
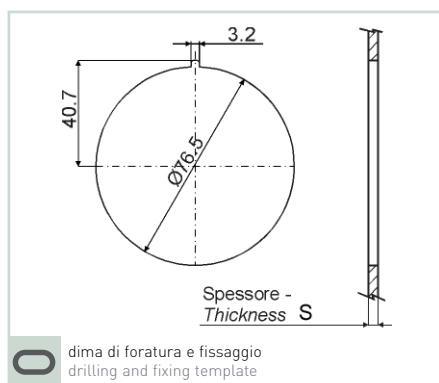
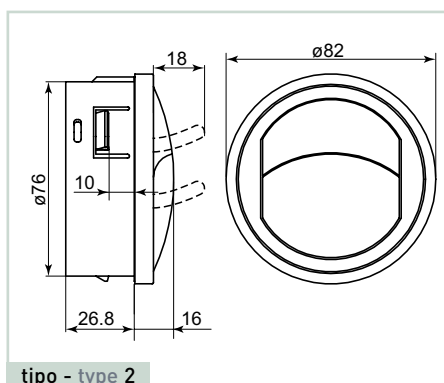
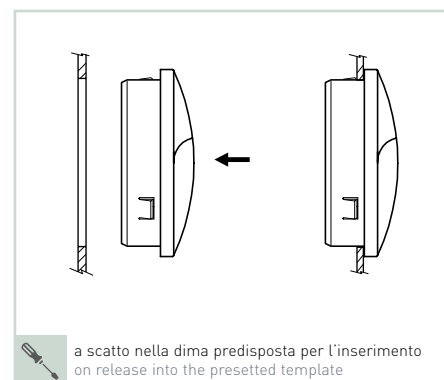
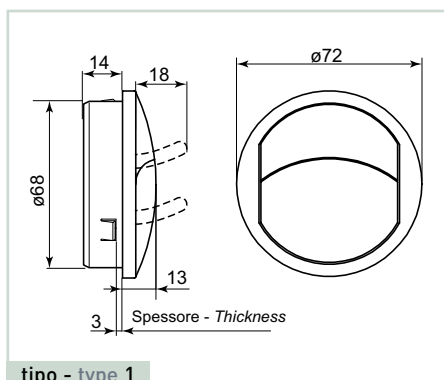

Esempi d'applicazione - Examples of application

