

# Maniglia per porta autista - Driver's door handle

## P.392

-  **Materiale - Material**  
Poliammide fibra vetro + anti-UV, Acciaio, Ottone  
Glass fibre polyamide + anti-UV, Steel, Brass
-  **Colore - Colour**  
Nero - Black
-  **Pezzi confezione - Package items**  
1 pezzo - piece
-  **Volume confezione - Package volume**  
6,55 dm<sup>3</sup>
-  **Peso confezione - Package weight**  
430 g
-  **Accessori - Accessories**  
vedi sez. tecnica - see technical section
-  **Carico di rottura a 20°C - Breakup load at 20°C**  
-
-  **Temp. di esercizio - Working temp.**  
-10/+120 °C
-  **Normative - Norms**  
R107.8; R118.3; FMVSS 302; ISO 3795; REACH (SCIP number at page A4-A5);  
ROHS; CMR.  
More info on page A4-A5 and website on "Directives and regulations" area.



**P.392** <sup>m</sup>  
**manual**

**Cod.**

J2  67249

## P.392

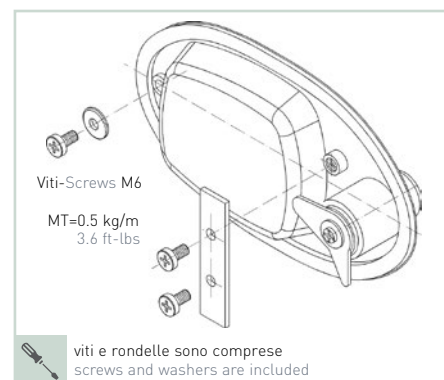
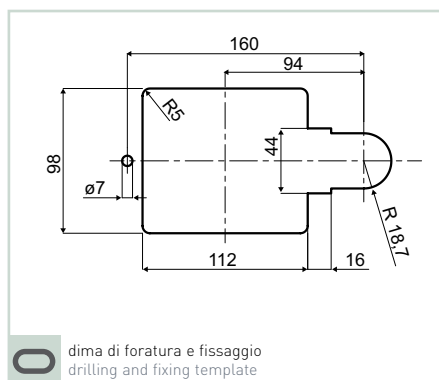
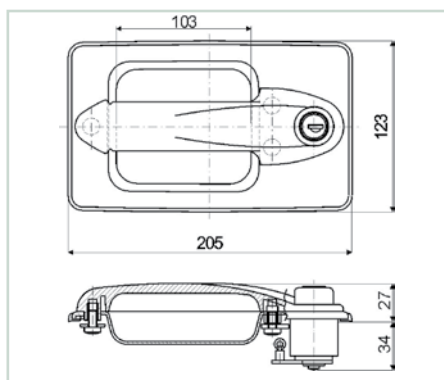

### ■ Inserimento - Assembly P.474

- 1 La serratura si presenta come in figura
- 2 Inserire la serratura nel modo indicato con la lamella rivolta verso lo scivolo (ulteriori info pag.A3), previo ingrassaggio preliminare. Chiave rimovibile con maniglia chiusa e aperta

- 1 The lock is as in figure
- 2 Insert the lock as shown, with the fin facing the chute (more info page A3), after preliminary greasing. Removable key with both locked and unlocked handle

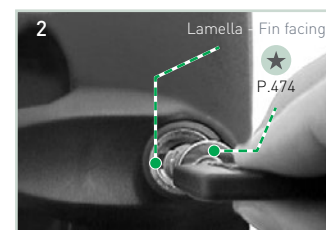
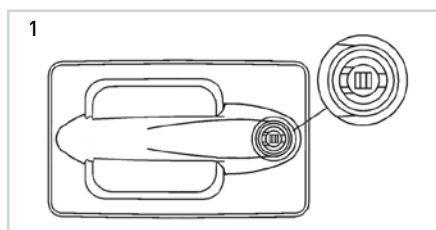

### ■ Esempi d'applicazione - Examples of application

